

Exhibit D

Project No. 4268-02
November 21, 2014

Dan Biswas
CJS Development II, LLC
5111 N. Scottsdale Road, Suite 200
Scottsdale, Arizona 85250

Reference: *10166 Alta Sierra Drive*
APN 25-430-08
Nevada County, California

Subject: *Response to County Comments Regarding Sewage Disposal*

Dear Mr. Biswas,

At your request, we are responding to comments prepared by Nevada County Community Development Agency, Planning Department dated November 7, 2014. Our responses specifically address the comments from the Environmental Health Department.

ENVIRONMENTAL HEALTH

6. The current proposal for sewage disposal includes an off-site septic system and leach field .

- a. Provide the design/waste flow calculations for the restaurant structure to the north to ascertain that the area tested on October 7, 2014 is large enough to accommodate a system replacement of any specific type on APN 25-430-12.

Response: Serge Bartlome, the current owner of the defunct restaurant, has indicated that the building will not be used for a restaurant, but will most likely be either a coffee grinding facility or church. The flows will vary depending on property usage. We anticipate that if the existing leach field fails, a new system could be placed on the same parcel, APN 25-430-12. Based on the percolation rates that we calculated for that parcel, the same lineal feet of pressure dosed leach line could have a design capacity of 3,290 gallons per day (corresponding to the design flow resulting from a 65-seat restaurant). Alternate daily flows would need to be calculated for other uses.

- b. Demonstrate all dimensions (lengths, width, and depth) of the existing and installed leach trench lineal footage on APN 25-430-10.

Response: We engaged Navo & Sons to locate the existing leach field and septic tank on August 22, 2014. The attached Figure 1 shows the location of the lines with respect to the building closest to Little Valley Road. The lines are 115 feet long, 3 feet wide and 42 inches deep.

- c. By calculating design waste flow (gallage per day) from all existing structures served by this existing system the assumption has to be that the three structures currently located on APN 25-430-10 are served by the same septic system and there is no other indication of other septic systems located on this parcel.

Response: Neither our firm nor Navo & Sons detected any other leach field or tanks around the three buildings on the site. Therefore we assume that the three structures are served by the identified system. The system is currently working with no signs of leach line failure. If the system were to fail, we recommend that new leach lines be installed between the building above the existing system and between the two leach lines. A new pressure dose system in this area could yield design flows for up to 40 employees. Slightly more than the available parking spaces currently there.

The propane tank on the lot may need to be relocated if the system needs expansion, or replacement.

- d. Please submit a Service Providers Report and site sketch plan for the existing septic systems previously mentioned above.

Response: The Service Provider is Navo & Sons. Serge Bartlome will provide documentation of past monitoring and maintenance of the system. A sketch of the system for APN 25-430-12 was located in the Nevada County online file system. A sketch of the system located on APN 25-430-12, as identified by Navo & Sons in the field, is attached as Figure 1.

We thank you for using our firm for your project. Please feel free to contact our office if you have any questions regarding our recommendations.

Sincerely,

HOLDREGE & KULL

Chuck Kull, C.E.G. 1622
Principal Engineer



Attachments: Figure 1
Calculations

F:\1 Projects\4268 10166 Alta Sierra Dr\4268-02 Wastewater\4268-02 Response to Comments.doc

Exhibit D (cont.)

LITTLE VALLEY ROAD

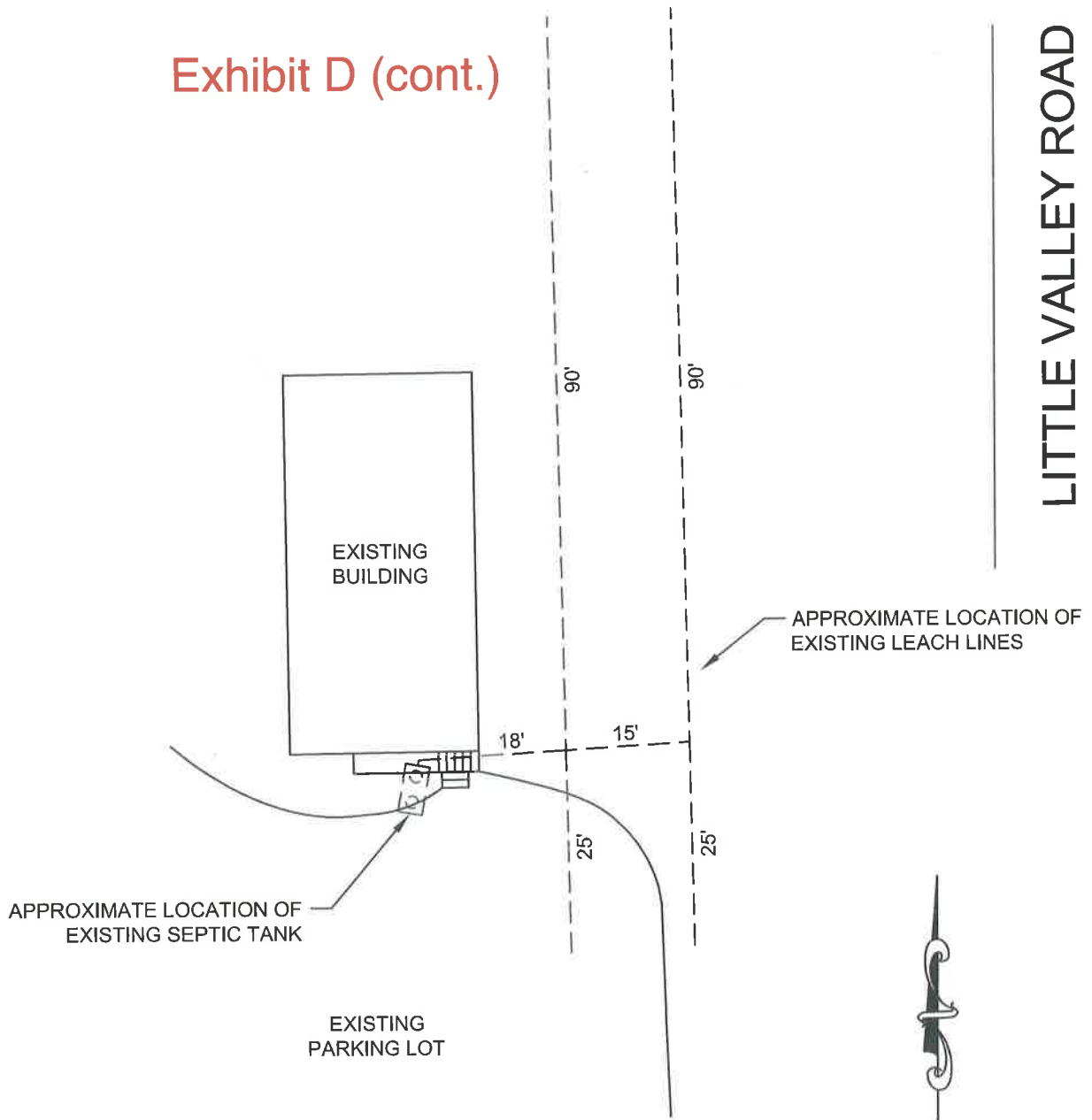

APN 25-430-10

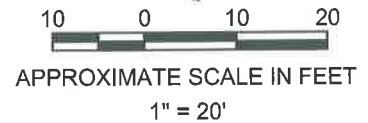

HOLDREGE & KULL
CONSULTING ENGINEERS • GEOLOGISTS



702 SEARLS AVENUE
NEVADA CITY, CA 95969
(530) 478-1305 FAX 478-1019

EXISTING SEPTIC SYSTEM LAYOUT
10166 ALTA SIERRA DRIVE
GRASS VALLEY, CALIFORNIA

PROJ NO.: 4268-01

DATE: NOVEMBER 2014

FIGURE NO.: 1

Project No.: 4268-01

Date: 11/17/14

Initials: CEX

Project Title: DOLLAR GENERAL

1 inch = ____ ft.

NOT TO SCALE X

Flows to APN 25-430-12

ASSUME PERC RATE OF 15 MP/L, PERC RATE
WAS APPROXIMATELY 1-2 MP/L

PRESSURE DOSE

$$\frac{5}{\sqrt{15}} = 1.3 \text{ GAL/DAY/FT}^2$$

$$3' \text{ WIDE} \sim 3.87 \text{ GPD/LF}$$

$$850 \text{ LF} \sim 3,290 \text{ GALLONS}$$

$$50 \text{ GALLONS / CUSTOMER} \sim 65 \text{ CUSTOMERS}$$

Flows on APN 25-430-10

PRESSURE DOSE

15 GALLONS/EMPLOYEE

$$\frac{5}{\sqrt{15}} = 1.28 \text{ G/5F/DAY} \sim 3' \text{ LONG} - 3.87 \text{ GPD/FT}$$

$$230 \text{ LONG} \sim 896 \text{ GPD}$$

$$3 \text{ UTILITY SINKS} \sim 300 \text{ GALLONS}$$

$$\therefore \frac{590}{15} \approx 39-40 \text{ EMPLOYEES}$$



NEVADA CITY
530.478.1305

TRUCKEE
530.587.5156

YUBA CITY
530.820.9234

CHICO
530.894.2487

JACKSON
209.223.0160